

OPTONICA

USER MANUAL

SKU: 15308 / 15309

Install

1



Turn Off the Power

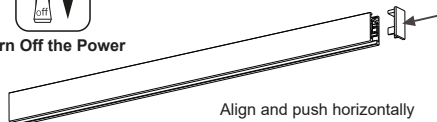

Align and push horizontally

2

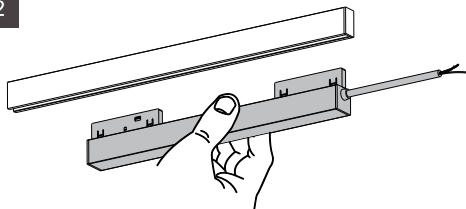

Align with the track and insert vertically

3

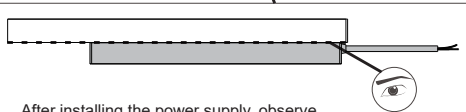
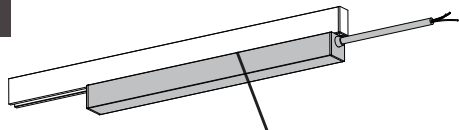

After installing the power supply, observe whether the power supply is firm and completely flat on the magnetic track with a "click" sound feedback

4

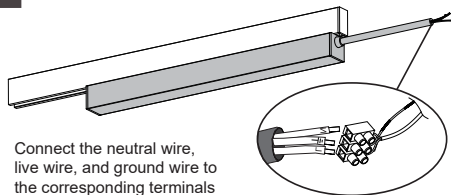

Connect the neutral wire, live wire, and ground wire to the corresponding terminals

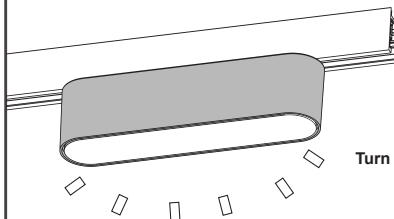

Turn On the Power

After installation, turn on the power. If the light fixture does not light up, Turn off the power, remove all devices and check for any abnormalities before reinstalling

Disassemble

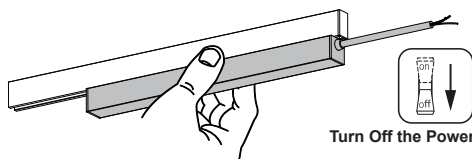

Turn Off the Power

Please hold onto the power and unplug it directly

